

Products > Sapphire Nozzles > SP-160

Sapphire Nozzles - SP-160

Specifications

| | |
|------------------------|----------------------------|
| Model | SP-160 |
| Inside Diameter | .0095/.0110" |
| Length | .302/.322" |
| Large O.D. | .089/.090" |
| Small O.D. | .030/.040" |
| Type | Tapered OD sapphire nozzle |

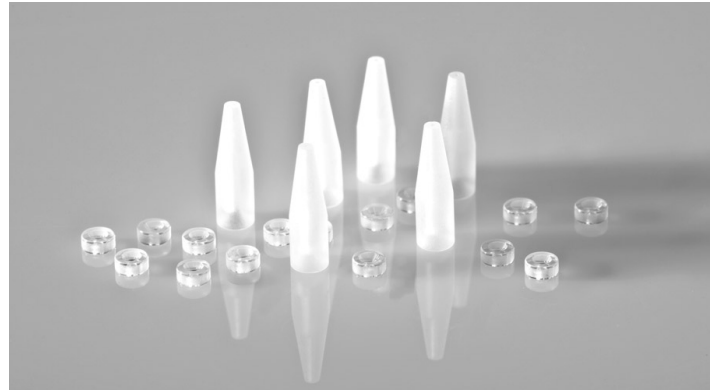

Description

Sapphire Nozzles are used where a longer Inner Diameter to Length ratio is desired. Using sapphire nozzles will provide longer life than using metal and we can hold tighter tolerances due to sapphires acceptance of higher surface finish.

Typical Applications

- Gas & Air Flow
- Wafer Jet Cutting & Cleaning
- Ink Jet Printing

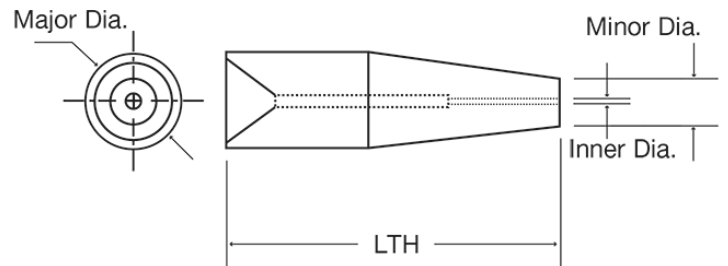

NOT SEEING EXACTLY WHAT YOU NEED?

We specialize in creating a wide range of custom optical components and custom mechanical components including a variety of shapes - from internal holes and tapers to outer flanges, angles and surface finishes. Contact us and we will consult with you to create a custom component that meets all of your specifications.